

Contactor, Size 14, 3-pole, AC-3, 335kW, 400/380 V (690 V)  
 Auxiliary switch 44 (4NO+4NC) AC operation 200...240 V AC 50/60 Hz



Figure similar

<b>Product designation</b>	Vacuum contactor
<b>Product type designation</b>	3TF6
<b>General technical data</b>	
<b>Size of contactor</b>	14
<b>Protection class IP</b>	
• on the front	IP00
<b>Reference code acc. to DIN EN 81346-2</b>	Q
<b>Ambient conditions</b>	
<b>Ambient temperature</b>	
• during operation	-25 ... +55 °C
<b>Main circuit</b>	
<b>Number of poles for main current circuit</b>	3
<b>Number of NO contacts for main contacts</b>	3
<b>Number of NC contacts for main contacts</b>	0
<b>Operating current</b>	
• at AC-3	

<ul style="list-style-type: none"> <li>— at 400 V rated value</li> <li>• at AC-4 at 400 V rated value</li> </ul>	<p>630 A</p> <p>300 A</p>
<b>Operating power</b>	
<ul style="list-style-type: none"> <li>• at AC-1 <ul style="list-style-type: none"> <li>— at 400 V rated value</li> </ul> </li> <li>• at AC-3 <ul style="list-style-type: none"> <li>— at 400 V rated value</li> </ul> </li> <li>• at AC-4 at 400 V rated value</li> </ul>	<p>415 kW</p> <p>335 kW</p> <p>168 000 W</p>

#### Control circuit/ Control

<b>Type of voltage of the control supply voltage</b>	AC
<b>Control supply voltage at AC</b>	
<ul style="list-style-type: none"> <li>• at 50 Hz rated value</li> <li>• at 60 Hz rated value</li> </ul>	<p>200 ... 240 V</p> <p>200 ... 240 V</p>
<b>Control version of the switch operating mechanism</b>	conventional

#### Auxiliary circuit

<b>Number of NC contacts for auxiliary contacts</b>	
<ul style="list-style-type: none"> <li>• instantaneous contact</li> </ul>	4
<b>Number of NO contacts for auxiliary contacts</b>	
<ul style="list-style-type: none"> <li>• instantaneous contact</li> </ul>	4

#### Installation/ mounting/ dimensions

<b>Mounting type</b>	screw fixing
<ul style="list-style-type: none"> <li>• Side-by-side mounting</li> </ul>	Yes
<b>Height</b>	232 mm
<b>Width</b>	230 mm
<b>Depth</b>	237 mm

#### Connections/Terminals

<b>Type of electrical connection</b>	
<ul style="list-style-type: none"> <li>• for main current circuit</li> <li>• for auxiliary and control current circuit</li> </ul>	<p>screw-type terminals</p> <p>screw-type terminals</p>

#### Certificates/approvals

General Product Approval	Functional Safety/Safety of Machinery
--------------------------	---------------------------------------



[Type Examination Certificate](#)

Declaration of Conformity	Test Certificates	Marine / Shipping
---------------------------	-------------------	-------------------



[Type Test Certificates/Test Report](#)

[Special Test Certificate](#)

[Miscellaneous](#)



Marine / Shipping	other
-------------------	-------



[Miscellaneous](#)

[Environmental Confirmations](#)

[Confirmation](#)

### Further information

**Information- and Downloadcenter (Catalogs, Brochures,...)**

<http://www.siemens.com/industrial-controls/catalogs>

**Industry Mall (Online ordering system)**

<https://mall.industry.siemens.com/mall/en/en/Catalog/product?mlfb=3TF6844-0CM7>

**Cax online generator**

<http://support.automation.siemens.com/WW/CAXorder/default.aspx?lang=en&mlfb=3TF6844-0CM7>

**Service&Support (Manuals, Certificates, Characteristics, FAQs,...)**

<https://support.industry.siemens.com/cs/ww/en/ps/3TF6844-0CM7>

**Image database (product images, 2D dimension drawings, 3D models, device circuit diagrams, EPLAN macros, ...)**

[http://www.automation.siemens.com/bilddb/cax\\_de.aspx?mlfb=3TF6844-0CM7&lang=en](http://www.automation.siemens.com/bilddb/cax_de.aspx?mlfb=3TF6844-0CM7&lang=en)

**Characteristic: Tripping characteristics, I<sup>2</sup>t, Let-through current**

<https://support.industry.siemens.com/cs/ww/en/ps/3TF6844-0CM7/char>

**Further characteristics (e.g. electrical endurance, switching frequency)**

<http://www.automation.siemens.com/bilddb/index.aspx?view=Search&mlfb=3TF6844-0CM7&objecttype=14&gridview=view1>

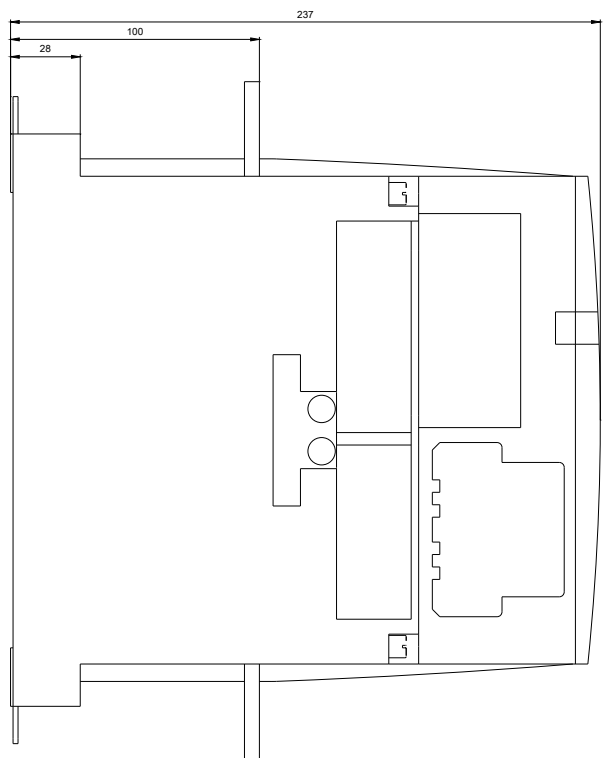
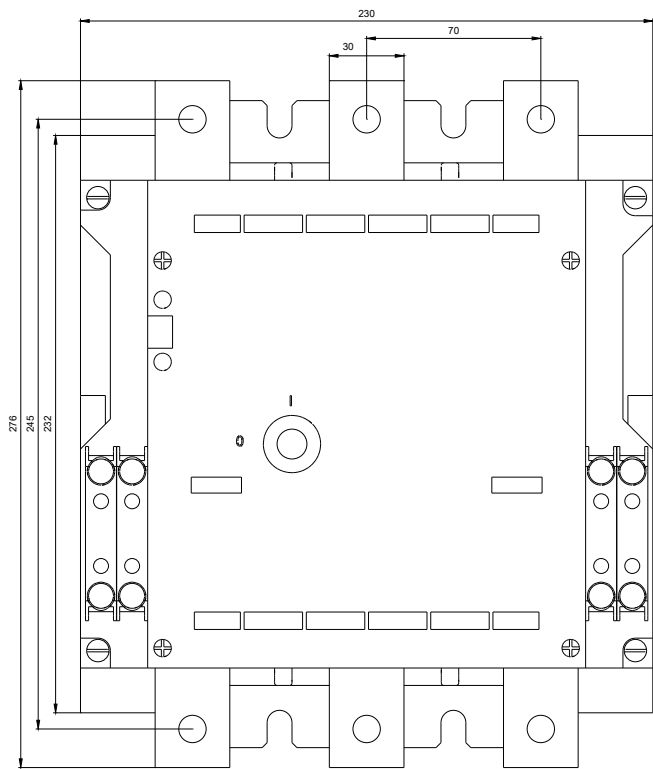

last modified:

12/13/2018